

Protecta FR Acrylic - Concrete Wall Single-sided Gap

Installation Instructions

1. Before installing Protecta® FR Acrylic ensure that the surface of all service penetrations and surrounding construction is free from all loose contaminants, dust and grease.
2. Where Protecta® FR Acrylic is to be installed against surfaces that cannot tolerate direct contact; appropriate surface preparation should be made (contact Polyseam for guidance in these cases). For paints sensitive to sealing compounds, priming with a PVA primer is recommended.
3. When installing any backing material, cut this slightly oversize and insert into the gap ensuring a tight friction fit. Ensure correct depth is achieved.
4. Fill the gap or joint with Protecta® FR Acrylic to the required depth.
5. Apply the sealant generously to prevent air bubbles. Finish the bead with a moist spatula, pallet knife or brush.
6. Protecta® FR Acrylic can be over-painted with most emulsion or alkyd (gloss) paints.

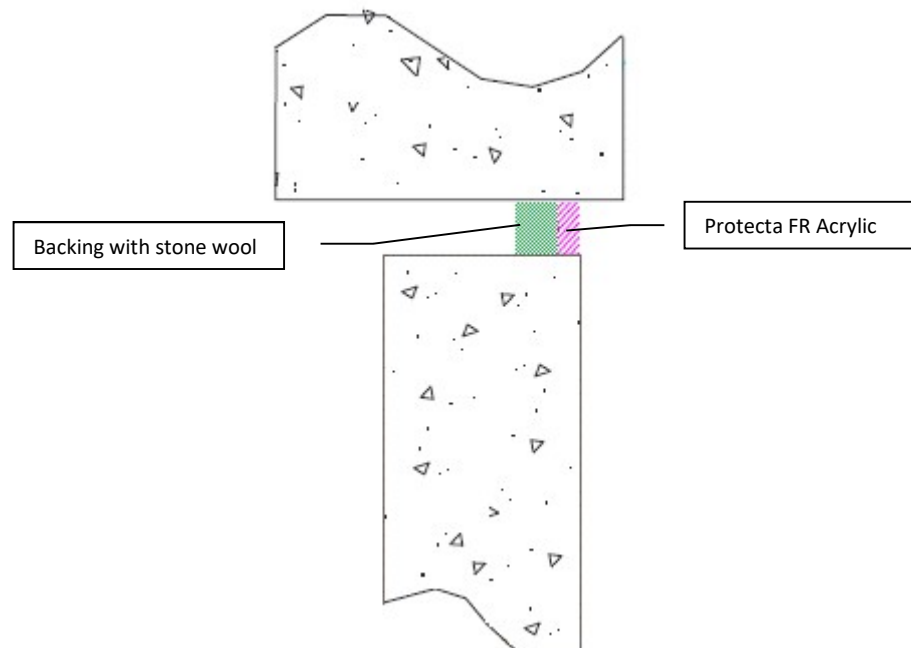

FPA Register / System ID# FC111

| | |
|---------------------|---|
| Products | Protecta FR Acrylic Stone wool |
| Application | Fire rated linear seals in rigid walls or between wall and floor |
| Construction | Minimum wall thickness of 150mm and comprise concrete, aerated concrete or masonry, with a density of $\geq 650 \text{ kg/m}^3$ |

Fire & Sound classification

Horizontal seal depth 25mm, max width 30mm, stonewool 40kg/m^3 20mm deep FRR -/240/60 or stonewool 40kg/m^3 48mm deep FRR -/240/120

Horizontal seal depth 10mm, max width 50mm, stonewool 33kg/m^3 60mm deep FRR -/240/60

Vertical seal depth 10mm, max width 50mm, stonewool 33kg/m^3 60mm deep FRR -/120/120

Wall thickness reduced to 75mm permitted with FRR of seal reduced to FRR of wall.

ZERO smoke leakage up to 200Pa

Sound reduction (seal only) STC 62

As a part of our policy of on-going product development and testing, we reserve the right to modify, alter or change product specifications without giving notice. All information contained in this document is given in good faith and is provided for guidance only. Any drawings provided are for illustrative purposes only. As Polyseam has no control over the methods or competence of installation and of prevailing site conditions, no warranties, expressed or implied, is intended to be given as to the actual performance of the product mentioned or referred to herein and no liability whatsoever will be accepted for any loss, damage or injury arising from the use of the information given.

For all technical details on the products specified please refer to the technical data sheets that can be found on www.firestopcentre.co.nz

Signed and approved: